

110031S VOLANTE ROMA

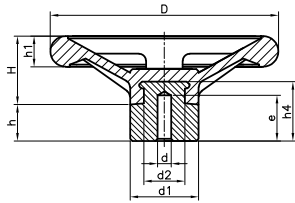

Código	D	H	d	e	d2	h4	d1	h	h1	Color
11003110601	100	31	5,25	20	22	26	30	16	13,5	Negro
11003112601	125	37	8	25	28	32	40	22	14	Negro
11003115601*	150	50	10	30	30	55	50	30	18	Negro
11003117601	175	51	10	30	30	55	50	30	20	Negro
11003120601	200	70	10	30	30	55	50	30	26	Negro
11003130601*	300	98	10	30	34	60	60	18	30	Negro

(*) 5 radios

Núcleo de hierro tratado.
PF: Resina fenólica negra FS 31 DIN 7708.